

COUNTY OF CAMBRIA, PENNSYLVANIA CITIZEN'S FINANCIAL REPORT

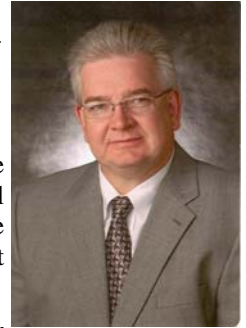

FOR THE YEAR ENDED DECEMBER 31, 2015
PREPARED BY THE OFFICE OF THE CONTROLLER, ED CERNIC, JR.

² *A Message from the Controller*



To The Residents of Cambria County:

2015 once again proved to be a challenge for Cambria County Government, and the services that are provided by us. The information assembled in the following pages will allow you to gain knowledge of the operations of your County Government. All of the information relating to the financial aspect of the County is derived directly from the Audit by the Independent Auditing firm of Wessel & Company.

As stated in previous Citizen's Reports prepared by the Controller's Office, the County struggled to provide timely payments to vendors and agencies throughout the year. In 2015, this was complicated by the State of Pennsylvania not passing their Annual Budget until about nine months after the due date of July 1, 2015. This lack of action not only amplified our financial struggles, but also other County Governments and School Districts across the State. Cambria County did not have a plan for dealing with funding shortfalls in our own Budget, but then we were faced with the fact of not receiving millions of dollars expected from the State to help operate our Human Service Agencies. Being an election year there was reluctance by the Commissioners to raise taxes or reduce or delay services.

In November 2015, the Commissioners were forced to borrow \$11.7 million from a local bank for unfunded debt that had built up partially due to the State budget impasse. A large portion of this loan was used to satisfy the \$7 million Tax Anticipation Loan borrowed on January 5, 2015 that was due by December 31, 2015. Therefore, we were forced to not pay all the outstanding bills owed at that time.

A new Board of Commissioners took office in January 2016, reopened the budget, and acted to provide a realistic revenue source for the budget as needed. We are optimistic that Cambria County is responsibly addressing the total operations of the County and acting to give the taxpayers an honest, transparent, realistic management of the tax dollars. It took a few years for the County to get to this low point at December 31, 2015, and all the corrections to solve this situation will not be made in one year, however I believe we are finally on the right track.

Again as always, I would like to acknowledge my superb staff for their dedication to me and the Taxpayers of Cambria County. They are as follows: Kristine Segear - 1st Deputy/Senior Accounting manager; Dana Descavish - 2nd Deputy/Pension Specialist; Amber Hamilton and Emily Krug - Internal Auditors/Accountants; Debbie Markum - Accounts Payable Coordinator; and Pam Paronish, Eva Shevock, and Sabrina Loughran - Accounting Assistants. This past year Sally Wess moved to another Department, and Barb Reese retired from my Office.

With All Best Wishes,

A handwritten signature in blue ink that reads "Ed Cernic, Jr." with a stylized flourish at the end.

Ed Cernic, Jr.
Cambria County Controller

Contact information:

Controllers Office:
Phone: (814) 472-1620
Fax: (814) 472-5358
Controller's email:
ecernic@co.cambria.pa.us

TABLE OF CONTENTS

Controller's Message.....	2	County Revenues vs Expenses	9
Welcome to Cambria County.....	3	Health Care Costs.....	10
History of Municipalities.....	3	Retirement OPEB.....	10
General Obligation Debt	4	Liquid Fuels	11
Component Units	5	County Prison.....	12
Children & Youth, Juvenile		Veteran Services Office.....	12
Court & Detention/Shelter.....	5	Court of Common Pleas.....	13
Real Estate Taxes.....	6	In the Spotlight.....	14
Real Estate Properties	7	Elected Officials.....	15
General Fund Rev & Exp.....	8	Guide to County Government....	16
County Financial Position	8		

WELCOME TO CAMBRIA COUNTY!

3

Cambria County is nestled in the heart of the Allegheny Mountains and was created on March 26, 1804. It was the 41st County formed in Pennsylvania and is home to the world's steepest vehicular inclined plane.

Cambria County is made up of 63 political subdivisions, consisting of the City of Johnstown, 32 boroughs and 30 townships with the Borough of Ebensburg being the County seat. In this publication and future publications, we will be providing a brief history of the city, boroughs and townships of Cambria County.

The County has a population of approximately 144,000, based on the 2010 Census, and covers 692 square miles. Cambria County is a 4th class County. Cambria County is home to 6 colleges and universities, 14 public school districts and many private and parochial schools, as well as many historic sites, state parks and local museums.

The County currently employs 760 full and part-time people and has 1,076 retirees.

History of Municipalities



The early 1800's saw the development of Cambria County into settlements. The immediate area in and near the future site of the borough of Patton was initially surveyed by Count Sedloski in 1829. The first settlers in the valley known as "Polish Corners", later known as "Marks Mills", and later to become "Patton", are reported to be enterprising men and their presence here is easily explained by following the valley's natural waterway, "Chest Creek". Although no

specific records exist to document the dates of these men's residence, legend contends that these men were gainfully self-employed as either trappers, traders, farmers or lumbermen at Polish Corners as early as 1844. Patton was named to honor John Patton and his son, A.E. Patton, whose tireless efforts were powerful factors in the incorporation and development of the new town. Other pioneers in this work were Honorable James Kerr, General John Magee, A.G. Palmer, George S. Good, and others after whom streets are named. In 1895, the Patton Clay Manufacturing Company was incorporated. It became one of the largest clay manufacturers in the world making clay products that were used worldwide to build such things as the Panama Canal. For more information on Patton Borough visit: www.pattonboro.com



Formed from Conemaugh Township in 1833, Richland Township was named "for the quality of the land therein." With the opening of the Pennsylvania Canal three years earlier, merchandising in the Johnstown area increased and farmers in the surrounding locales such as Richland found it quite profitable to sell in the city. This economic expansion brought more sawmills and more land cleared for farming. In the following decade, the booming iron manufacturing industry brought slow-but-steady growth to Richland as more merchants and businessmen arrived in the area to provide supplies, furnishings and housing to the growing workforce. The era following the Civil War was one of innovation and improvement. Telephone service, streetcar lines and the first gas station were among the technological advances arriving in the region during this time; however, the establishment of a strong school system had the most far-reaching impact on

the young people in Richland Township. The last 80 years have borne witness to many changes in Richland. The rise of the steel industry following World War II turned Richland into a comfortable middle-class suburb of Johnstown as well as a thriving retail and commercial district to meet the needs of the new residents. The airport and Route 219 enabled people and products to move in and out of the region more easily, while the construction of the University of Pittsburgh branch campus and the Johnstown-Cambria County Industrial Park demonstrated a commitment to improving education and expanding employment. For more information on Richland Township visit: www.richlandtwp.com

Photos throughout the book courtesy of various public internet sources, unless noted.

General Obligation Debt

As of December 31, 2015, the County's general obligation debt was \$56,850,245.

Taxpayer's Debt Funding

The County designated 4.125 mills of tax to Debt Service in 2015.

Approximately \$5 million of Taxpayer's dollars were used to fund the County's Debt in 2015.

General Obligation Debt (In Millions)



Due to the Commonwealth of Pennsylvania's budget impasse for the 2015-2016 fiscal year, State funding was not released to Counties, Municipalities, School Districts and other Agencies until the Governor signed a partial budget on December 29, 2015. State funds relating to July through December 2015 were released to the County beginning in January 2016.

In result, Cambria County issued a General Obligation Note in the amount of \$11,696,916 in November of 2015 in order to fund general operating expenses during the time of the State budget impasse and pay the \$7 million Tax Anticipation Loan due December 31, 2015. The General Obligation Note was paid off in May of 2016.

In November 2015, the County issued General Obligation Bonds in the amount of \$96,787 through the United States Department of Agriculture Rural Housing Service. Of this bond issuance, \$49,900 relates to funding the 911 communication improvements and \$48,400 relates to the purchase of new vehicles for the Sheriff's Department, Adult Probation, and Juvenile Court.



	2012	2013	2014	2015
2006 Notes	\$ 3,442,112	\$ 3,131,297	\$ -	\$ -
2006 Loan	6,423,974	6,197,455	-	-
2006 A&B Notes	8,895,139	8,506,444	-	-
2007 Lease	7,380,206	6,465,372	-	-
04/05/08/09 Lease	1,024,638	703,897	507,038	401,542
2009 Lease	1,292,473	1,008,971	-	-
2011 Notes	25,460,000	23,765,000	-	-
2013 Lease	-	5,000,000	-	-
2014 GO Bond	-	-	48,625,000	44,655,000
2015 Loan	-	-	-	11,696,916
2015 USDA Loan	-	-	-	96,787
	<u>\$ 53,918,541</u>	<u>\$ 54,778,436</u>	<u>\$ 49,132,038</u>	<u>\$ 56,850,245</u>

On July 30, 2014, Standards and Poor's had rated Cambria County at a BBB (Stable) credit rating.

Component Units of Cambria County

5

The following chart illustrates the amount of County Taxpayer Dollars spent to fund the Component Units.

	2012	2013	2014	2015
Penn Highlands Community College *	\$ 1,205,000	\$ 1,205,000	\$ 1,055,000	\$ 1,055,000
Cambria Library Association *	615,000	615,000	615,000	615,000
Transit Authority	558,131	517,003	547,069	577,463
Solid Waste Management Authority	378,850	342,000	338,700	338,700
Johnstown-Cambria County Airport	176,750	174,000	174,000	174,000
Conservation and Recreation Authority *	135,740	130,000	155,000	155,000
War Memorial Authority	125,300	46,700	150,000	150,000
Economic Development Authority	-	125,000	150,000	75,000
Planning Commission	86,387	64,836	64,200	64,200
Redevelopment Authority	66,500	63,000	60,000	60,000
	<u>\$ 3,347,658</u>	<u>\$ 3,282,539</u>	<u>\$ 3,308,969</u>	<u>\$ 3,264,363</u>

State and/or Federal funds that are passed through Cambria County or released directly to the Component Unit are not included in the Chart above. Behavioral Health of Cambria County is not included in the chart above because their County funding is comprised of State pass through funds only.

* In 2015, Cambria County designated .875 mills of tax for the Community College, .50 mills for the County Library, and .50 mills for Parks and Recreation. The dedicated tax for Parks and Playgrounds is distributed to the Conservation & Recreation Authority, War Memorial, North Central Recreational Center, and Duman Park.

Children & Youth, Juvenile Court, and Detention/Shelter

The chart below illustrates the amount of County Taxpayer Dollars provided to the Children & Youth, Juvenile Court, and Detention/Shelter Funds due to the excess expenditures over revenues for each year. The two final columns list the total 2015 expenditures and the percentage of County Taxpayer Dollars of the total expenditures for each fund.

	County Taxpayer Funding				2015	2015
	2012	2013	2014	2015	Total Fund Expenditures	County's Taxpayer %
Children & Youth	\$ 1,393,122	\$ 1,535,365	\$ 1,466,214	\$ 1,970,670	\$ 9,345,099	21.1%
Juvenile Court	1,509,280	1,725,719	1,848,508	1,712,707	3,077,965	55.6%
Detention/Shelter	667,779	683,892	611,048	809,202	1,543,943	52.4%
	<u>\$ 3,570,181</u>	<u>\$ 3,944,976</u>	<u>\$ 3,925,770</u>	<u>\$ 4,492,579</u>	<u>\$ 13,967,007</u>	

Children & Youth – The PA Department of Human Services provides the majority of the funding for this program to provide child protective services to the age of 21, through counseling, in-home, and residential services.

Juvenile Court – The PA Department of Human Services, PA Commission on Crime and Delinquency, and the Juvenile Court Judges Commission also provides funding to administer the entire Juvenile Court process.

Detention/Shelter – This program is funded by contracts with 19 counties, including Cambria County, to house delinquent children. The Detention Home is a 24-hour maximum security facility for youth ages 10-18. The Shelter is staffed as a 24-hour secure facility for youth ages 10-18 with a 30 day limit.

In April 2016, the County Commissioners approved the closing of the Juvenile Detention/Shelter Center effective June 2016.

6 Your Real Estate Taxes — The County's Portion

The following illustrates how your County Real Estate tax dollars were spent in 2015:



In 2015, County residents paid approximately \$921 in local real estate taxes (county, municipal and school district) on each \$10,000 of assessed property value. Of that, \$295 or 32% is paid to the County, as illustrated in the pie chart.

Cambria County's millage rate is 29.5 mills, with each mill generating approximately \$1.28 million in taxes.

On average 93% of the County's real estate taxes are collected during the current tax year with a majority or 82% of the taxes being collected during the discount period. At the end of 2015 approximately \$2.6 million (*at face*) or 6.93% in unpaid taxes were turned over to the Tax Claim Bureau. During 2015, the Tax Claim Bureau collected \$2.4 million worth of delinquent taxes for tax years 2010 through 2014.

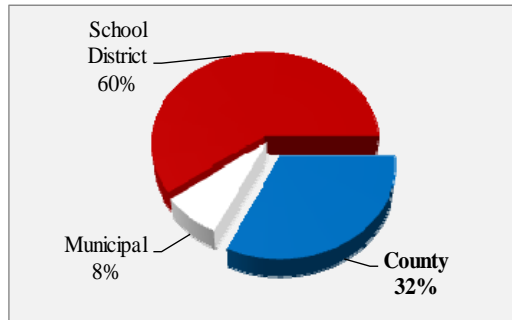

The majority (70% or \$87.5 million) of the County's spending is funded by state and federal grants, charges for services, investments and other income. The remaining (\$36.9 million) must be paid primarily with your County real estate taxes.

	Millage Rates			
	2012	2013	2014	2015
General Purposes	23.500	23.500	23.500	23.500
Debt Service	4.000	4.000	4.125	4.125
Community College	1.000	1.000	0.875	0.875
County Library	0.500	0.500	0.500	0.500
Parks & Playgrounds	0.500	0.500	0.500	0.500
Total millage rates	29.500	29.500	29.500	29.500

Real Estate Properties by Property Type

7

The following represents the total assessed value of Cambria County properties by type of property. The second chart shows the Real Estate Dollars billed by property type. The Cambria County Assessment Office maintains and updates property records for the valuation of real property for ad valorem taxation.

Assessed Value Comparison by Type (in Millions)

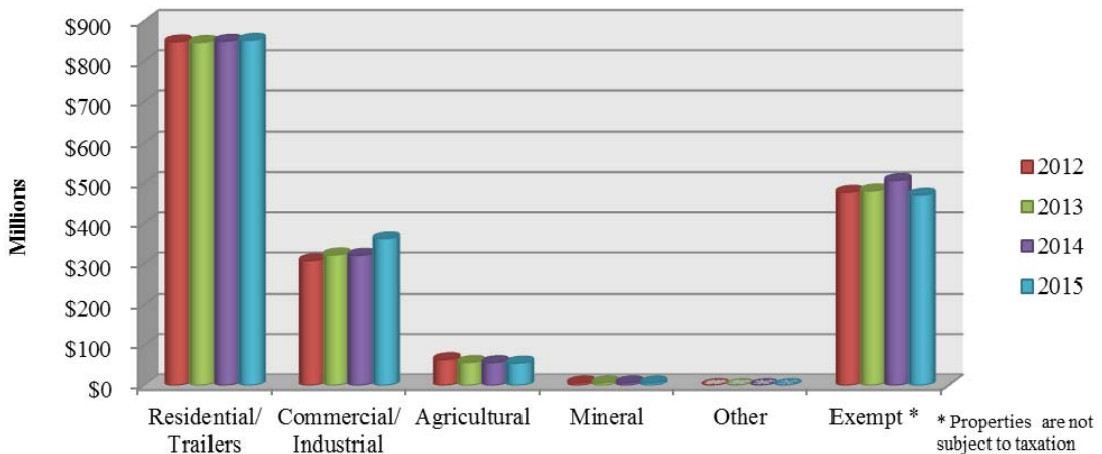

Real Estate Tax Dollars by Type (in Millions)

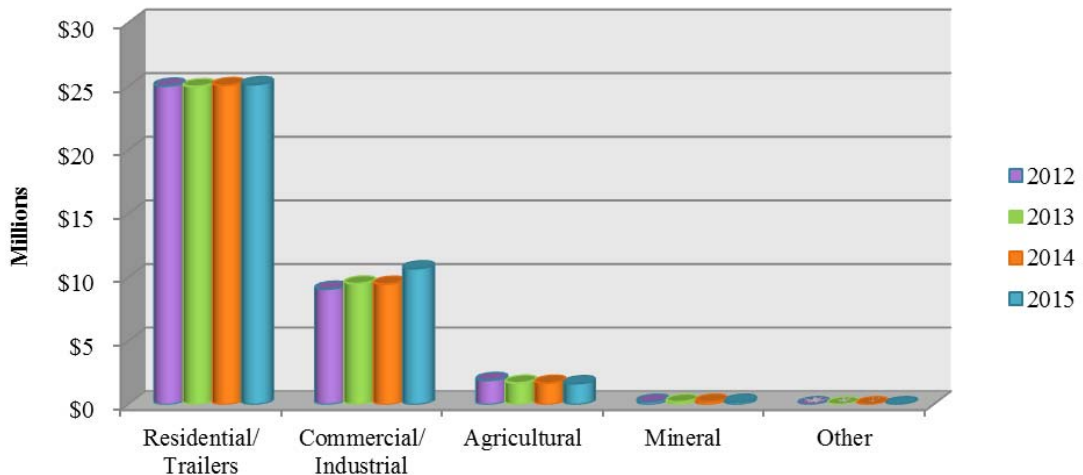

General Fund Revenues and Expenses

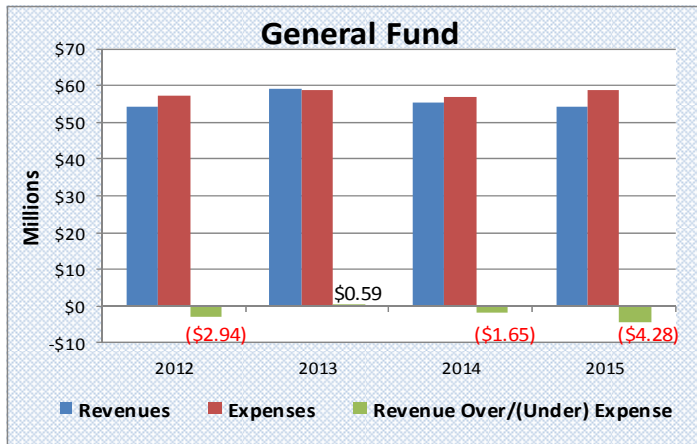

County Financial Position

The County's financial position, below, shows the County's resources versus the amount owed at year-end for the governmental and business type activities.

Assets	<u>2012</u>	<u>2013</u>	<u>2014</u>	<u>2015</u>
Current Assets				
Cash and investments	\$ 4,838,794	\$ 6,765,469	\$ 5,876,616	\$ 5,933,987
Other current assets	14,096,478	14,154,858	17,565,441	29,853,040
Capital assets and other	59,229,049	56,863,499	54,794,978	54,441,683
Total Assets	78,164,321	77,783,826	78,237,035	90,228,710
Deferred Outflows	305,947	231,810	892,162	20,357,516
Liabilities				
Current liabilities	20,135,855	20,448,787	24,573,359	42,049,458
Non-current liabilities	51,730,245	51,946,751	46,435,308	82,708,295
Total Liabilities	71,866,100	72,395,538	71,008,667	124,757,753
Deferred Inflows (Revenues)	2,883,565	2,913,905	7,230,769	7,008,284
Net Position	\$ 4,652,439	\$ 2,706,193	\$ 889,761	\$ (21,179,811)

In 2015, the County had implemented GASB 68, *Accounting and Financial Reporting for Pension Plans*. The Net Position for 2015 reflects a present value measurement of the Pension Plan's projected benefit to current active and inactive employees. This measurement is based upon employees past years of service, less the amount of the pension plan's fiduciary net position.

The 2015 Net Position of (\$21.2) million is made up of a one time (\$16.5) million prior period adjustment for the implementation of GASB 68.

County Revenues and Expenses

9

The chart below illustrates a four year trend in the County's Revenues and Expenses.

Revenues	2012	2013	2014	2015
Taxes	\$ 35,763,448	\$ 36,003,545	\$ 36,273,997	\$ 36,852,124
Operating Grants & Contributions *	68,144,154	73,433,864	77,271,232	74,226,232
Charges for Service	11,902,982	11,540,377	10,001,914	10,108,797
Interest & Investment Income	41,532	31,206	24,660	23,801
Reimbursed Expenses/Other Income	3,076,429	2,630,291	2,344,320	2,416,122
Total Revenues	118,928,545	123,639,283	125,916,123	123,627,076
Expenses				
Administrative	\$ 9,334,707	\$ 14,610,736	\$ 10,024,427	\$ 9,954,954
Judicial	11,471,545	12,753,192	11,680,255	12,430,916
Corrections	15,987,237	16,078,650	17,229,243	17,369,057
Public Safety	8,889,886	7,288,842	8,469,914	9,270,462
Debt Service	5,468,232	5,073,512	3,914,683	5,841,908
Human Service *	62,307,241	62,706,805	67,560,961	67,656,709
Conservation	1,953,658	2,329,032	1,951,220	1,160,347
Housing	1,184,125	1,186,201	1,869,954	1,633,341
Highways/Streets	1,737,492	1,701,734	1,616,802	1,878,938
Culture/Recreation	1,164,960	1,016,858	1,278,813	1,352,485
Total Expenses	119,499,083	124,745,562	125,596,272	128,549,117
Other Financing Sources/(Uses)	(2,987,766)	3,729,464	(2,584,199)	(56,995)
Net (Deficiency)/Excess	\$ (3,558,304)	\$ 2,623,185	\$ (2,264,348)	\$ (4,979,036)

In 2015, pass-through Grants for the Mount Aloysius Project and the Redevelopment Authority had decreased by \$2.5 million and \$1 million respectively, contributing to the total decrease in County revenues.

Expenses for 2015 for Debt Service had increased by \$1.9 million due to the August 2014 refinancing of County debt. Overall, 2015 expenses had increased in all categories with the exceptions of Administration, Conservation and Housing.

* Note: The 2014, Operating Grants and Contributions revenues and Human Service expenses were reduced by \$8,235,599 due to the 2014 Audited Financial Statements recording of the Block Grant in both the Human Service Fund and the Human Service Agencies.

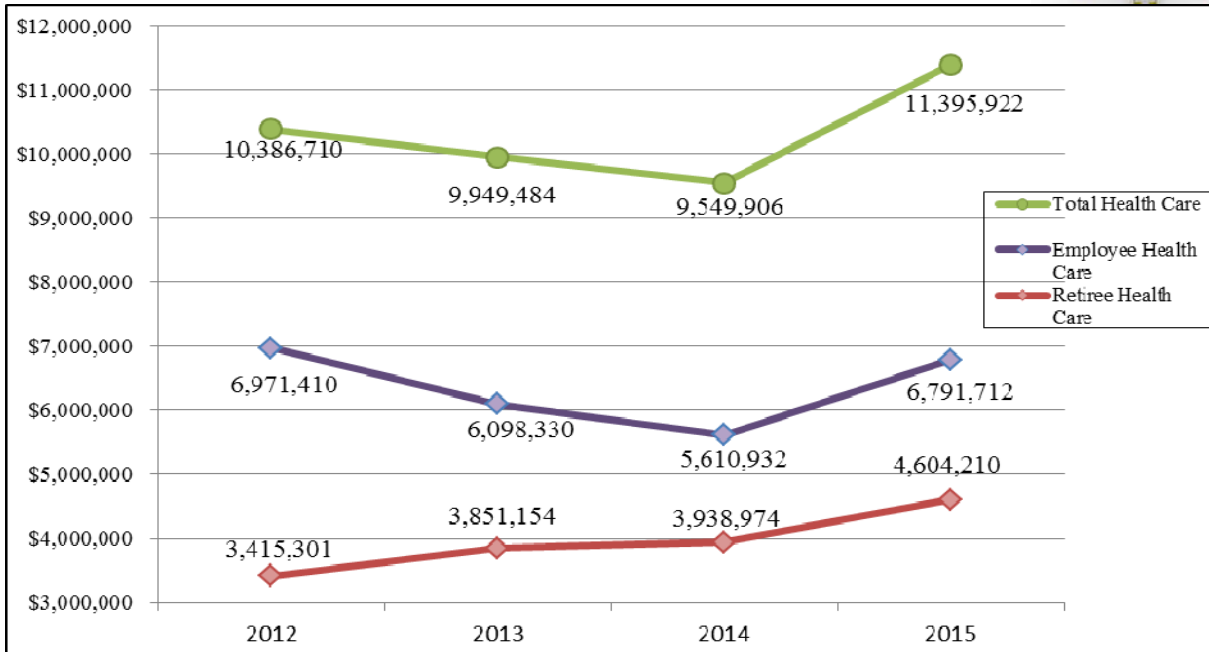

Photo credit: John Minnick/SFC Raymond Richard Buchan Memorial Scholarship (buchanscholarship.org)

Health Care Costs



Since 2011, Cambria County has been self insured for health care using UPMC to administer the plan. The chart below shows the total health care costs and the breakout of employee health care and retiree health care.



Other Post Employment Benefits Long Term Liability

Cambria County provides Retiree Health Insurance and Life Insurance to qualifying retirees. The chart below shows the Long Term Liability for these Other Post Employment Benefits (OPEB) for 2012 to 2015.

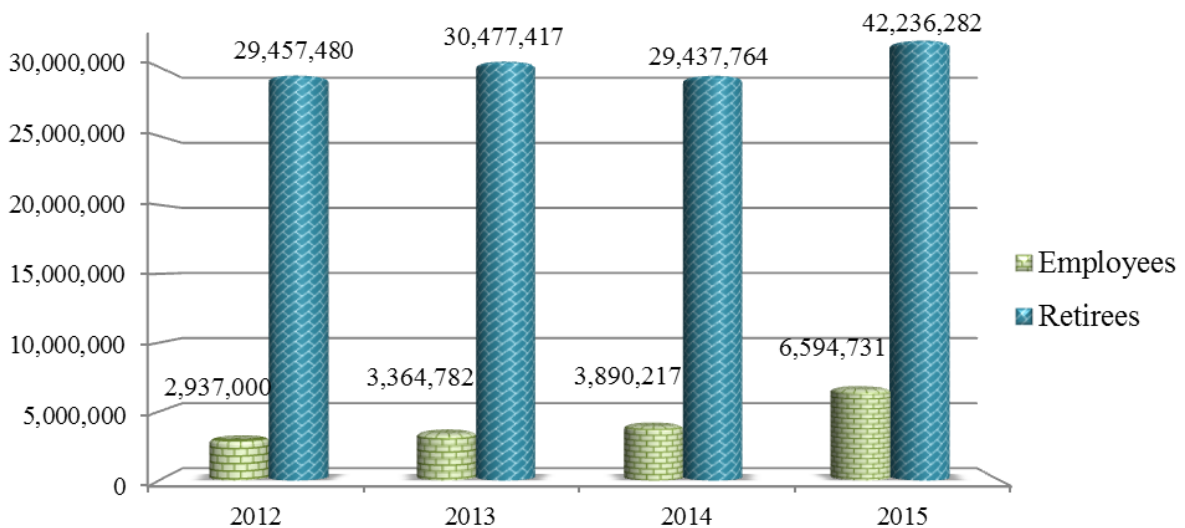

Liquid Fuels Fund

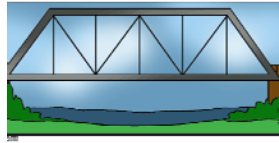

Cambria County receives grants from the State and Federal government to repair or replace County owned bridges. In addition, the County receives a portion of the overall State's liquid fuels tax. The County reallocates a portion of these amounts to all municipalities within Cambria County based upon their requests and the final decision of the County Commissioners. The remaining liquid fuels monies are used for bridge repair and maintenance.

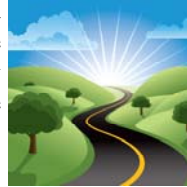

The list below shows the amount of 11 funds paid to Municipalities in 2015:

<u>Municipality</u>	<u>Amount Paid</u>
Adams Twp	\$ 18,000
Allegheny Twp	10,700
Ashville Boro	6,800 *
Barr Twp	11,750
Blacklick Twp	7,600
Brownstown Boro	4,100
Cambria Twp	17,600
Carrolltown Boro	4,500
Chest Twp	4,000
Clearfield Twp	6,900
Cresson Twp	20,000 *
Croyle Twp	9,200
Daisytown Boro	6,400 *
Dale Boro	9,200 *
Dean Twp	4,400
East Carroll Twp	7,800
East Conemaugh Boro	4,900
East Taylor Twp	25,200 *
Elder Twp	5,300
Franklin Boro	5,000
Gallitzin Twp	5,300
Geistown Boro	6,300
Hasting Boro	5,300
Jackson Twp	13,800
Lilly Boro	8,400 *
Middle Taylor Twp	9,200
Munster Twp	14,400 *
Nanty Glo Boro	16,000 *
Northern Cambria Boro	15,000
Patton Borough	11,600 *
Portage Boro	14,200 *
Portage Twp	10,500
Richland Twp	26,400
Scalp Level Boro	6,900
Stonycreek Twp	8,300
Summerhill Boro	19,200 *
Summerhill Twp	9,500
Susquehanna Twp	10,400
Upper Yoder Boro	23,800 *
Washington Twp	5,400
West Carroll Twp	6,400
West Taylor Twp	13,800 *
Westmont Boro	11,000
White Twp	4,000
Total Payments	\$ 464,450

Liquid Fuels Revenue

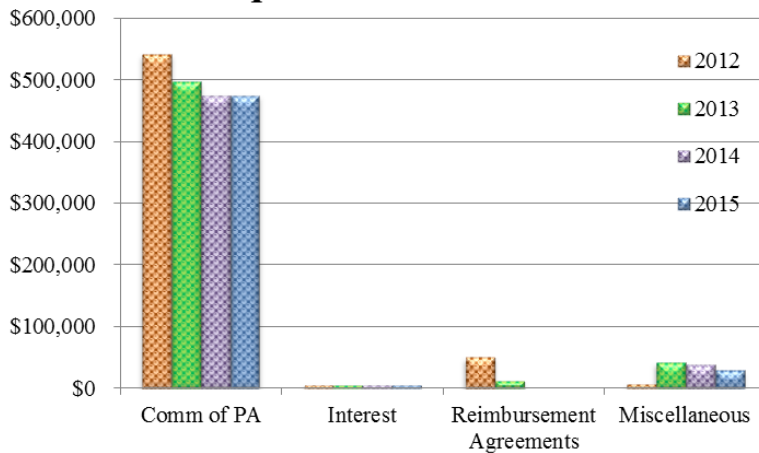

Liquid Fuels Expenses

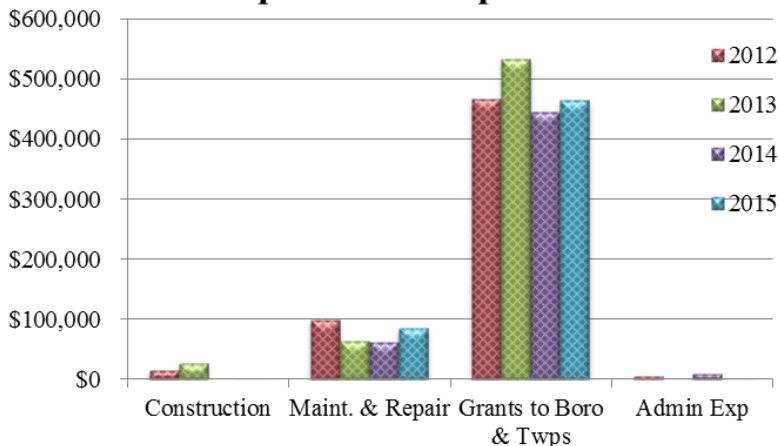

*Municipality's payment includes allocations from multiple years.

Cambria County Prison

During 2015, the Prison realized a net loss funded by the taxpayers of **\$6.8 million** vs 2014's net loss of **\$7.2 million**, as illustrated in the chart below.

The Prison has approximately 500 available beds for prisoners and houses County, State and Federal inmates. On average the Prison houses 70-75 State inmates and 30-35 U.S. Marshall inmates as well as, on occasion, other Counties' inmates. During 2015, the County received \$68 a day for January-August and \$72 a day for the remainder of the year for State inmates. The County receives \$51.53 a day for Federal inmates.

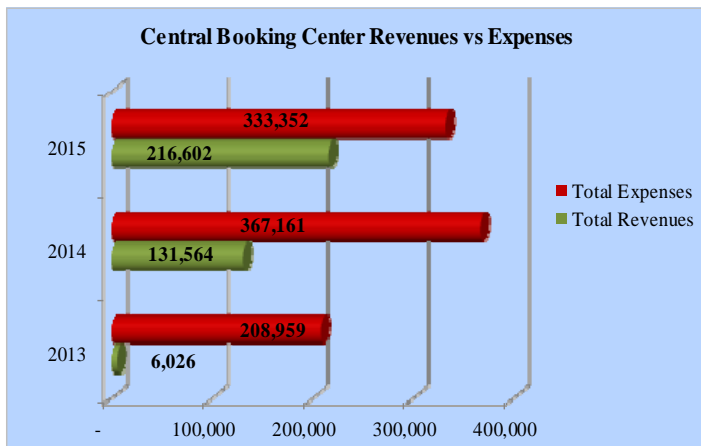
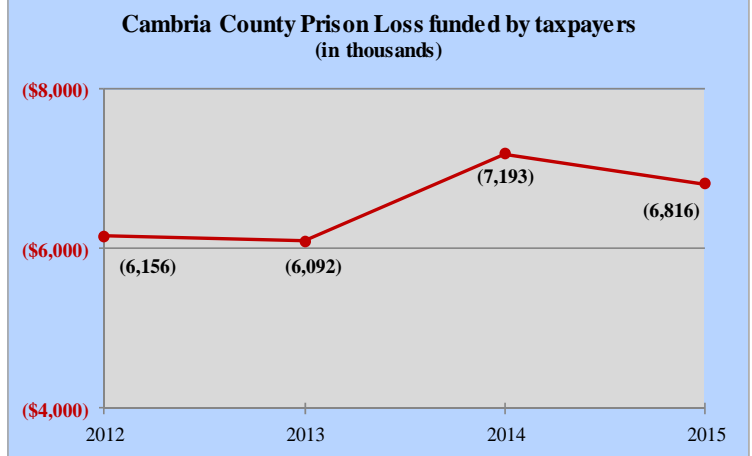

In 2013 the Central Booking Center was opened at the Prison. During 2015, 3,276 adult defendants were processed through Central Booking, 1,346 were fully booked with fingerprints and arraignments and 1,930 were fingerprint orders only from a District Magistrate. Also during 2015, 203 juvenile defendants were processed. Each adult defendant that is processed, fully or fingerprint only, is charged a \$200 booking fee which is paid to the County's Clerk of Courts and is split between the Booking Center (95%) and the County's General Fund (5%). In 2015 it cost taxpayers **\$116,750** to run the Booking Center vs **\$235,297** in 2014. As the chart

above illustrates, Central Bookings Revenues have increased each year since it opened in 2013.

Cambria County Department of Veteran Services

The County Department of Veteran Services advises, assists and counsels veterans and their families in the process necessary to obtain veteran benefits. The office establishes military claim data files on all veterans coming into the office. The office also distributes death benefit claims for deceased County veterans and transmits records to the Bureau of Veterans Affairs. Annually the office distributes U.S. flags and holders to various service organizations for placement on appropriate veteran's gravesites. In 2015, the office received a grant from the PA Department of Military & Veterans Affairs to purchase equipment to be able to provide ID cards to all Veterans.

Cambria County is fortunate to have numerous memorial/monument sites throughout the county that honors our service men and women. We have included photos of some of the many in this book. The cover: *Ebensburg Borough and Johnstown War Memorial*, Page 9: *Cresson Borough, Lilly-Washington Borough and Franklin Borough* and to the right: *East Hills, Richland Township*.



Cambria County Court of Common Pleas

13

The Pennsylvania court system is structured like a pyramid with the Supreme Court at the top. The Courts of Common Pleas are the general trial courts of Pennsylvania. They are organized by district with most districts following the boundaries of the counties, only a few are comprised of two counties. Each district has a president judge and court administrator. The Courts of Common Pleas are responsible for appeals from the minor courts, appeals not exclusively assigned to another court, and matters involving children and families. In Pennsylvania there are 451 Court of Common Pleas Judges, each Judge is elected to a 10 year term. The following are Cambria County's Court of Common Pleas Judges and their judicial assignments.

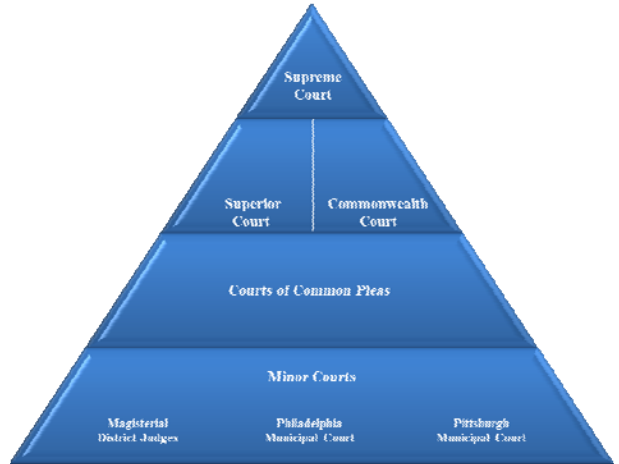

Honorable Norman A. Krumenacker, III,
President Judge

*Administration of the Courts,
Criminal and Civil*



Honorable David J. Tulowitzki

*Criminal, Civil, Juvenile
Delinquency, and Asbestos*



Honorable Linda Rovder Fleming

*Civil and Domestic: Custody,
Support, etc.*



Honorable Patrick T. Kiniry

*Criminal, Civil, and
Orphan's Court: Adoptions, Wills,
Trusts, etc.*

Honorable Tamara R. Bernstein

*Criminal, Civil, and Juvenile
Delinquency*



In the Spotlight



CAMBRIA COUNTY SHERIFF'S OFFICE



The Sheriff's Office consists of professional men and women who are empowered to defend the Constitution of the United States and the Commonwealth of Pennsylvania. The office is comprised of the Sheriff (elected), 6 office staff, 21 full time deputies and 9 per diem deputies who enforce all laws with fairness and diligence, while being committed to a strong partnership with all members of the community. The Sheriff's Office deems to maintain integrity, fairness, compassion and professionalism at all times. The office provides courthouse and courtroom security, which includes security for all witnesses, jurors and defendants. They provide prisoner transports which often involve out-of-county and out-of-state travel. They execute criminal arrests for bench warrants as a result of criminal or domestic relation arrests. They serve Protection from Abuse orders and various other civil papers, real estate posting, and levy on personal property which ultimately may result in conducting Sheriff Sales for personal property and real estate. They also serve Tax Sale notices which are furnished in conjunction with the Tax Claim Bureau's annual Upset Sale and provide security for all of the tax sales. This office is also responsible for issuing gun permits and licenses to sell firearms, and provides precious metals licenses. **The Sheriff's Office revenue totaled \$714,282 and expenses totaled \$2,208,325 of which \$1,948,069 were personnel related expenses for 2015.**

RECORDER OF DEEDS



It is the mission of the Recorder's Office to provide accurately-kept land records for public access and to assure knowledgeable, courteous assistance to those who utilize our services. The Recorder of Deeds Office records date back to 1804. The office is comprised of the Elected Official and 5 full time employees. The Recorder of Deeds office provides hands-on access to Cambria County's land records. The office records properly executed real estate documents and processes them to make them available for viewing. The office also assists the public in finding information, and provides services within the office to inform and assist lending institutions and attorneys' offices. The office collects Pennsylvania Realty Transfer Taxes. Other services provided are information on recording requirements, basic assistance and instruction on the use of office indexes and equipment, photocopies of office records and certification of record. The office also records military discharges and provides copies of those records to veterans without charge. **The Recorder of Deeds office revenue totaled \$430,324 and expenses totaled \$355,833 of which \$304,054 were personnel related expenses for 2015.**

CAMBRIA COUNTY ELECTED OFFICIALS

15



Board of Commissioners

From left: Mark Wissinger, Thomas Chernisky, Chairman; and William "B.J." Smith, Vice-Chairman



Ed Cernic, Jr., *Controller*

Insures the accuracy and legality of fiscal transactions, administers county pension fund, works with county tax collectors and constables, processes accounts payable.



Susan Kuhar, *Clerk of Courts*

Records all criminal court procedures, collects fines, costs and restitution for the Court of Common Pleas.



Jeffrey Lees, *Coroner*

Investigates sudden, unexplained violent, or suspicious deaths occurring in the County.



Kelly Callihan, *District Attorney*

Responsible for the prosecution of criminal activity occurring within the County.



Debbie Martella, *Prothonotary*

Keeper of Civil records for the courts, processes passports and provides free public access to naturalization records from the early 1800s.



Ray Wendekier, *Recorder of Deeds*

Records all deeds, mortgages, and land related papers for County properties and collects PA realty transfer tax.



Patty Sharbaugh, *Register of Wills & Clerk of Orphan's Court*

Issuer of marriage licenses, records inheritance tax, adoptions, birth and death records and wills and estates.



Robert Kolar, *Sheriff*

Responsible for security at County buildings; County law enforcement such as serving bench warrants, posts real estate notices, and issues gun permits.



Lisa Kozorosky, *Treasurer*

Collects County Real Estate taxes for the City of Johnstown and lodging room rental tax. Issues dog, hunting, fishing, bingo and small game of chance licenses.

Guide to County Government

<u>Office</u>	<u>Official</u>	<u>Phone</u>	<u>Email</u>
Commissioner	Thomas Chernisky	(814) 472-1600	
Commissioner	William "B.J." Smith	(814) 472-1600	
Commissioner	Mark Wissinger	(814) 472-1600	
Controllars	Ed Cernic, Jr.	(814) 472-1620	ecernic@co.cambria.pa.us
Clerk of Courts	Susan Kuhar	(814) 472-1540	skuhar@co.cambria.pa.us
Coroner	Jeffrey Lees	(814) 535-6222	lees@co.cambria.pa.us
District Attorney	Kelly Callihan	(814) 472-1680	
Prothonotary	Debbie Martella	(814) 472-1638	dmartella@co.cambria.pa.us
Recorder of Deeds	Ray Wendekier	(814) 472-1475	rwendekier@co.cambria.pa.us
Register of Wills	Patty Sharbaugh	(814) 472-1440	psharbaugh@co.cambria.pa.us
Sheriff	Robert Kolar	(814) 472-1690	sheriff@co.cambria.pa.us
Treasurer	Lisa Kozorosky	(814) 472-1643	lkozorosky@co.cambria.pa.us

Crisis Intervention Hotline	1-877-268-9463
Area Agency on Aging	(814) 539-5595
Behavioral Health / Intellectual Disabilities / Early Intervention Program	(814) 535-8531
Children & Youth Services	(814) 539-7454
Drug & Alcohol	(814) 536-5388
Cost & Fines	(814) 472-1551
Court Administrator	(814) 472-1552
Domestic Relations	1-800-638-4409
Duman Park	(814) 472-8390
Election Office	(814) 472-1464
Jury Selection Division	(814) 472-1501
Non-Emergency Number	(814) 472-2100
Tax Assessment Office	(814) 472-1451
Tax Claim Bureau	(814) 472-1445
Veteran Affairs	(814) 472-1590



Do you suspect Fraud or Abuse is occurring within Cambria County? Contact the Controller's Office.

To keep it confidential....

- Mail your tip to: The Controller's Office, 200 S Center St., Ebensburg, PA 15931
- Call (814) 472-1623